

FLANGED GAS BALL VALVE

25MM - 200MM



UNDERGROUND KEY CAP
STANDARD ON SIZES
DN80 AND LARGER



AGA APPROVED FLANGED ISOLATION VALVE

FUNCTION AND FEATURES

- | | |
|---------------------------------------|---------------------------------------|
| ■ European Design and Manufactured | ■ Full Bore Design |
| ■ Gas Approval; AGA 7517 (32mm-200mm) | ■ Underground Key Cap or Lever Handle |
| ■ Sturdy Ductile Iron Construction | ■ ISO 5211 Mounting Pad |

PRODUCT SPECIFICATIONS

PERFORMANCE	
WORKING TEMPERATURE	-20 - 60°C
MAX WORKING PRESSURE	1,600kPa
FLANGE CONNECTION	Table 'E' *
AGA APPROVAL	Licence 7517

* ANSI or DIN sizes available upon request

* 150mm size is drilled Table 'D' due to size / location of bolts on flange

MATERIALS		
1	BODY	DUCTILE IRON - GGG40
2	BALL	304SS
3	STEM	420SS
4	SEATS	PTFE
5	O-RING	VITON
6	HANDLE	IRON - ST 37-2

DIAGRAM

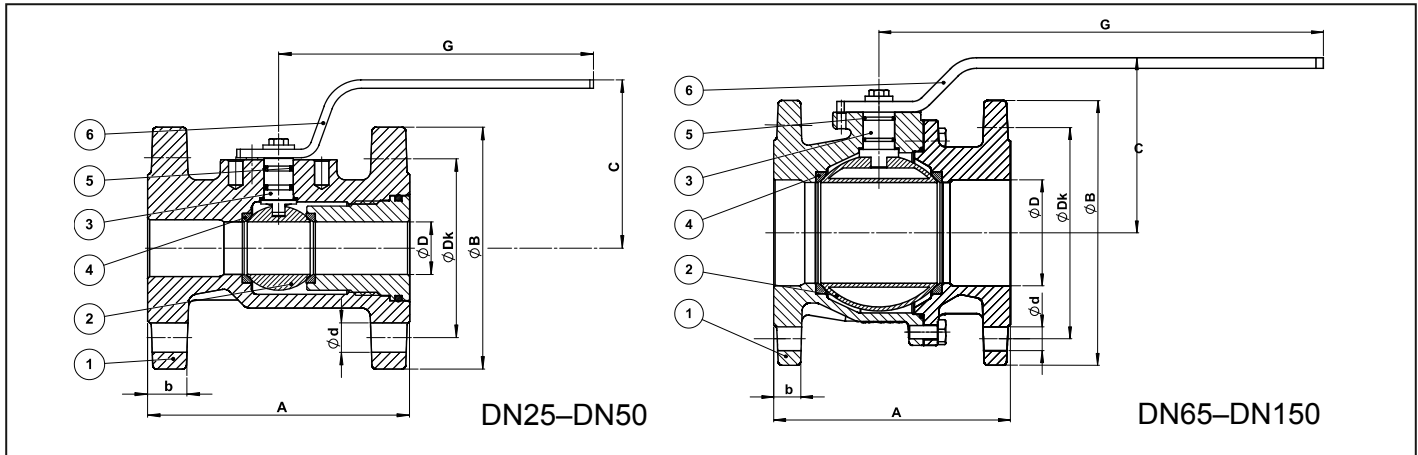

CODE	SIZE	A	ØB	C	ØD	G***	B	ØDK	ØD	NR.	FLANGE ISO	WEIGHT (KG)	TORQUE NM ****
GBVFE-025	25	125	115	76	25	150	18	83	M12*	4	F03	3.5	20
GBVFE-032	32	130	140	92	31	235	18	87	M12*	4	F04	5.6	25
GBVFE-040	40	140	150	97	39	235	18	98	M12*	4	F05	6.8	40
GBVFE-050	50	150	165	105	49	271	20	114	M16*	4	F05	8.7	55
GBVFE-065	65	170	185	124	63	288	18	127	18	4	F07	14.0	70
GBVFE-080	80	180	200	133	76	288	20	146	18	8	F07	17.5	80
GBVFE-100	100	190	220	153	100	288	20	178	18	8	F07	21.8	100
GBVFE-150	150	210	285	203	150	541	22	235	18**	8	F10	38.6	300
GBVFE-200	200	400	340	316	200	1000	24	292	22	12	F12	86.0	600

* Bolt holes are tapped and threaded due to size / location of bolts on flange

** 150mm size is drilled Table 'D' due to size / location of bolts on flange

*** DN80 - DN200 supplied with underground kep cap as standard

**** Based on 1,600kPa at 20°C with clean water, not including a safety factor.

For other specific operating conditions, the torque can increase.

VALVE OPTIONS



Lever Handle



Underground adaptor

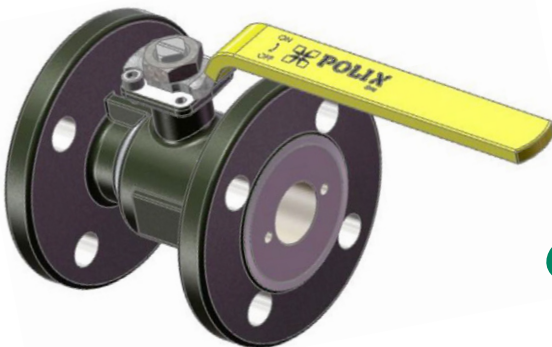

150724-01